

# NHTSA RECALL NOTICE #05E-064 - MIGHTYJOE 2 & 3

- 1** **VERIFY THAT YOU HAVE THE CORRECT PRODUCT** (see reverse).  
ONLY MightyJoe 2 & 3 produced after 2004 are affected.

- 2** **LOOSEN THE BOLTS INSIDE THE INNER HUBS.**

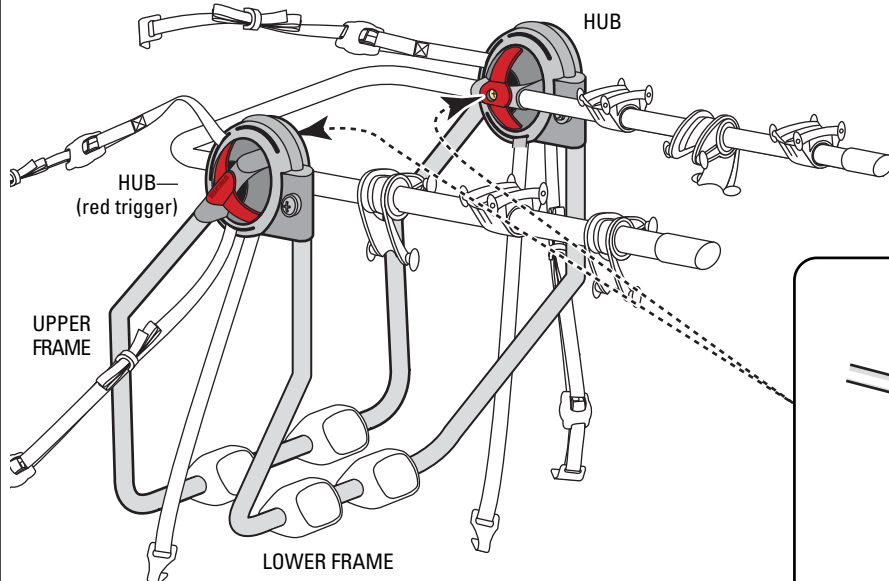

**TOOL REQUIRED:**  
Phillips screwdriver  
(crosshead)

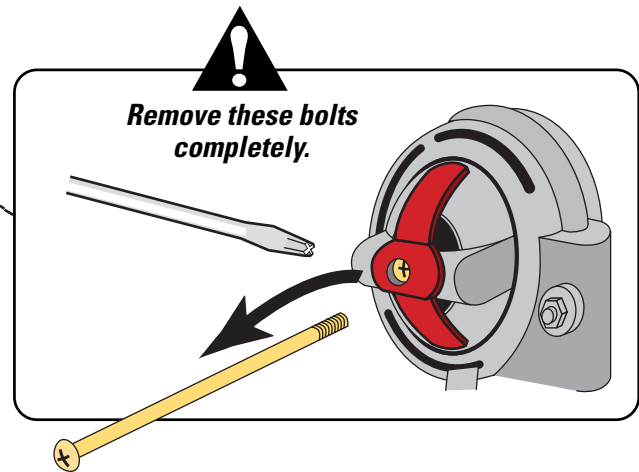

- 3** **Disassemble the upper frame from the hubs.**

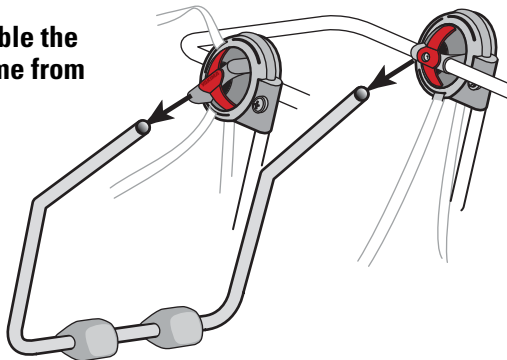

- 4** **Pull off both of the outer hubs.**

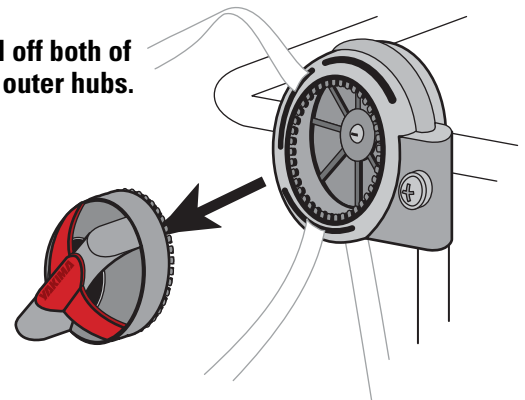

- 5** **Ship the two hubs in the pre-paid addressed mailer.**

*Hubs have red triggers, black body with gear teeth below.*

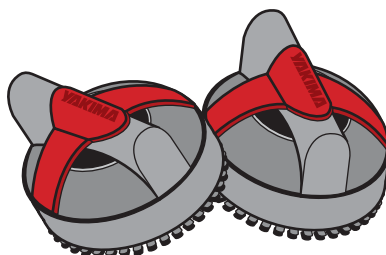

- 6** **Discard the remaining parts. Check with your local recycling center to dispose of the materials properly.**

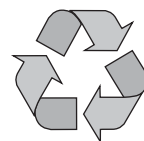

### MightyJoes 2005

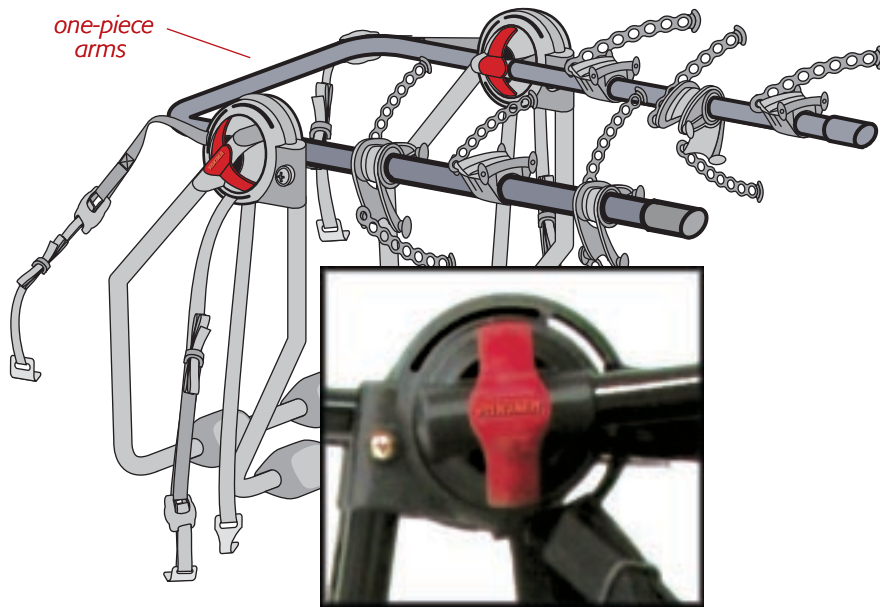

**MightyJoe 2 - # 02609**

**MightyJoe 3 - # 02608**

ONLY THE 2005 MIGHTY JOE PRODUCTS ARE BEING RECALLED.

The 2005 Mighty Joe design has characteristic round hubs with quick release triggers on both sides of the hubs.

The bars that carry bikes are connected directly to the round hub, and pivot on this hub. The point between bars and hubs is the design that is being recalled.

### MightyJoe 2004

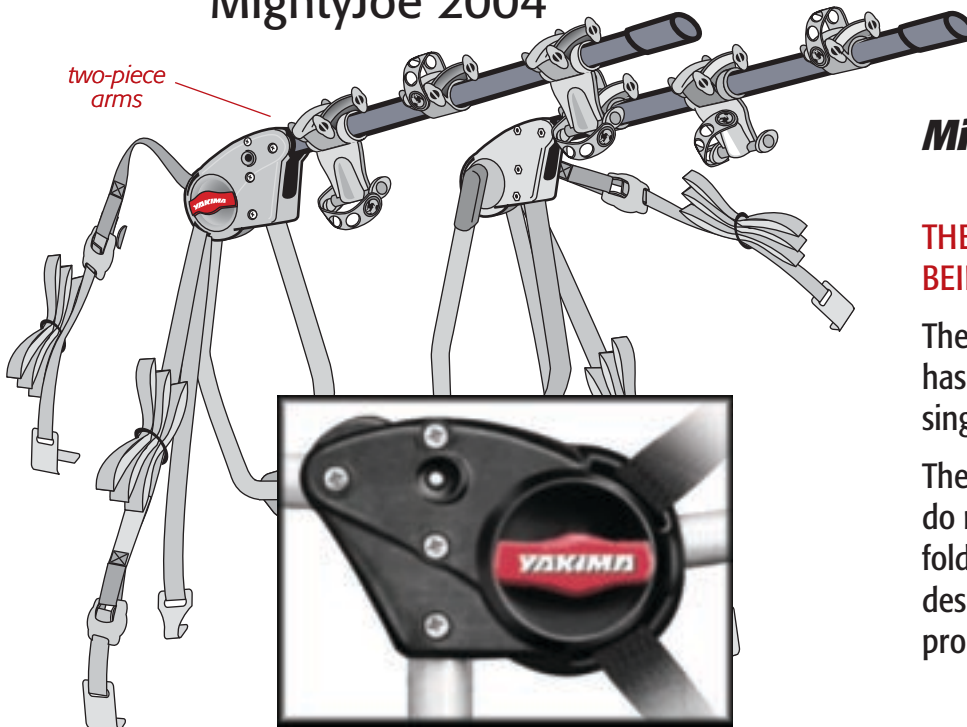

**MightyJoe - # 02607**

THE 2004 MIGHTY JOE IS NOT BEING RECALLED.

The 2004 Mighty Joe design has large molded hubs with a single trigger on each hub.

The bars that hold the bikes do not pivot on the hub, but fold down independently. This design continues to function properly.